

Luminaire

Ilbi+

109-331K-40GEE/840, B



Combining maximum usefulness with the minimalist design of Matúš Opalka gives you the Ilbi+ family of lighting. We have, moreover, added a dual function. In addition to lighting up the room indirectly, it charges electronic devices through an integrated USB port and acts as a suspension system for inserting hooks, handles or shelves. You can hang your clothes, place books, hang kitchen utensils, lay a towel or other everyday necessities on the luminaire. Ilbi+ luminaires are great for hotels, households, meeting rooms, and thanks to their IP 44 housing also for wellness centers, bathrooms and swimming pool dressing rooms.

Design Matúš Opálka

Type of installation	Wall mounted
Light distribution	Indirect
Luminaire shape	Angular
Colour of the luminaires	Black
Material	Aluminium
Lifetime	L80/B20 50 000 hours
Warranty	5 years
Description of luminaires	Luminaire wall mounted
item description	+USB left groove
Dimensions	1176 mm × 37 mm × 106 mm
Weight	3.9 kg
Light source	LED MODUL
Type of optical system	Opal diffuser
Luminous flux*	4740 lm
Colour Temperature	4000 K cool white
Luminous efficacy	123 lm/W
MacAdam Light source	3
Colour rendering index	80
UGR max. X=4H Y=8H, ρ=70,50,20	10

Technical drawing

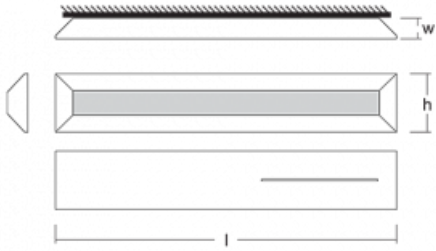

Luminaire power input* 38.6 W

Connection of the luminaires ON/OFF

Electrical voltage 220-240V

Frequency 50/60Hz

⊕ CE IP 20

*±10 %

Curve

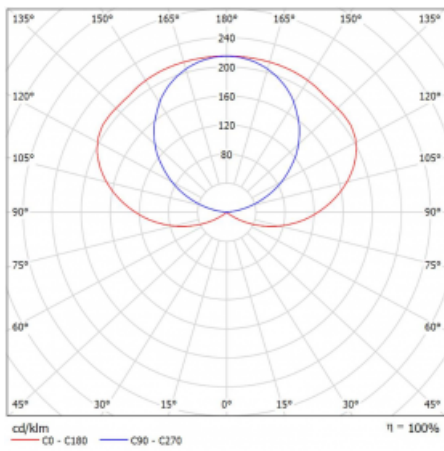

Downloads

Installation instructions



Photos



Accessories

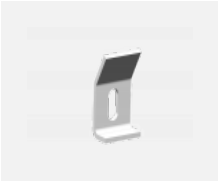

109-0001, F
wall fastening



109-0003, W
hook



109-0004, WD
shelf