



## Luminaire

# Ilbi+

109-301K-30GEE/830, B



Combining maximum usefulness with the minimalist design of Matúš Opalka gives you the Ilbi+ family of lighting. We have, moreover, added a dual function. In addition to lighting up the room indirectly, it charges electronic devices through an integrated USB port and acts as a suspension system for inserting hooks, handles or shelves. You can hang your clothes, place books, hang kitchen utensils, lay a towel or other everyday necessities on the luminaire. Ilbi+ luminaires are great for hotels, households, meeting rooms, and thanks to their IP 44 housing also for wellness centers, bathrooms and swimming pool dressing rooms.

**Design** Matúš Opálka

Type of installation	Wall mounted
Light distribution	Indirect
Luminaire shape	Angular
Colour of the luminaires	Black
Material	Aluminium
Lifetime	L80/B20 50 000 hours
Warranty	5 years
Description of luminaires	Luminaire wall mounted
item description	left groove
Dimensions	896 mm × 37 mm × 106 mm
Weight	2.8 kg
Light source	LED MODUL
Type of optical system	Opal diffuser
Luminous flux*	3400 lm
Colour Temperature	3000 K warm white
Luminous efficacy	117 lm/W
MacAdam Light source	3
Colour rendering index	80
UGR max. X=4H Y=8H, ρ=70,50,20	10

## Technical drawing

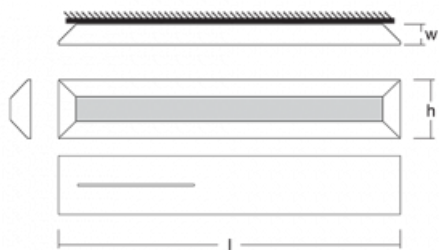

Luminaire power input\* 29 W

Connection of the luminaires ON/OFF

Electrical voltage 220-240V

Frequency 50/60Hz

⊕ CE IP 20

\*±10 %

## Curve

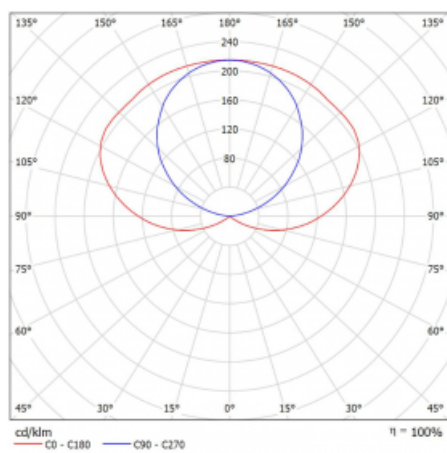

## Downloads

Installation instructions



Photos



## Accessories

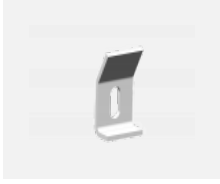

**109-0001, F**  
wall fastening



**109-0003, B**  
hook



**109-0004, BD**  
shelf